



**Underwriters Laboratories, Inc.**  
**Recognized Component Program — UL File Number E201546**

UL file number E201546 has been assigned to Keystone Electronics' "Quick-Fit" terminals (Refer to pages 44-47) indicating recognition by Underwriters Laboratories Inc. that they are in compliance with their component program.

Underwriters Laboratories Inc. component program assures that "Quick-Fit" terminals meet the dimensional and performance requirements of the National Electrical Manufacturers Association specification number NEMA2-1982-(1988) and UL310.



## .110 (2.8), .187 (4.8), .205 (5.2) MALE TABS

**.110 (2.8) TAB**

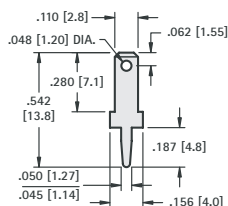

CAT. NO.	MATERIAL	MTG. HOLE
<b>1267</b>	.020 (.50) Brass, Tin Plate	.046 (1.2) Dia.
<b>1211</b>	.032 (.80) Brass, Tin Plate	.052 (1.3) Dia.

**.110 (2.8) TAB**

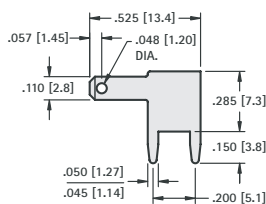

CAT. NO.	MATERIAL	MTG. HOLES
<b>4903</b>	.020 (.50) Brass, Tin Plate	.046 (1.2) Dia.
<b>4906</b>	.032 (.80) Brass, Tin Plate	.052 (1.3) Dia.

**.187 (4.8) TAB**

**STURDI-MOUNT**

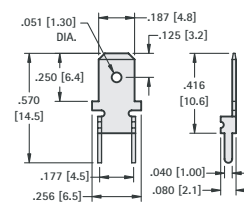

CAT. NO.	MATERIAL	MTG. HOLES
<b>4900</b>	.020 (.50) Brass, Tin Plate	.043 (1.1) Dia.

**.187 (4.8) TAB**

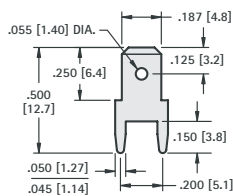

CAT. NO.	MATERIAL	MTG. HOLES
<b>1285</b>	.020 (.50) Brass, Tin Plate	.046 (1.2) Dia.
<b>1212</b>	.032 (.80) Brass, Tin Plate	.052 (1.3) Dia.

**.187 (4.8) TAB**

**STURDI-MOUNT**

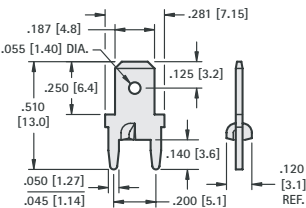

CAT. NO.	MATERIAL	MTG. HOLES
<b>1285-ST</b>	.020 (.50) Brass, Tin Plate	.046 (1.2) Dia.
<b>1212-ST</b>	.032 (.80) Brass, Tin Plate	.052 (1.3) Dia.

**.187 (4.8) TAB**

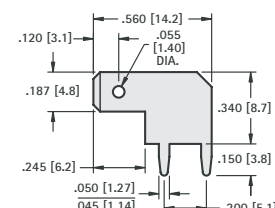

CAT. NO.	MATERIAL	MTG. HOLES
<b>4904</b>	.020 (.50) Brass, Tin Plate	.046 (1.2) Dia.
<b>4907</b>	.032 (.80) Brass, Tin Plate	.052 (1.3) Dia.

**.205 (5.2) TAB**

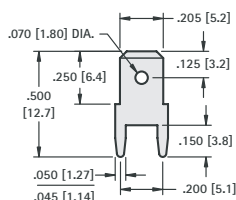

CAT. NO.	MATERIAL	MTG. HOLES
<b>1286</b>	.020 (.50) Brass, Tin Plate	.046 (1.2) Dia.
<b>1213</b>	.032 (.80) Brass, Tin Plate	.052 (1.3) Dia.

**.205 (5.2) TAB**

**STURDI-MOUNT**

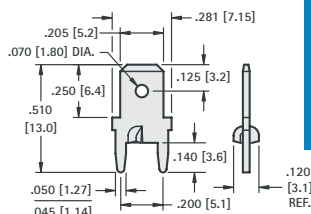

CAT. NO.	MATERIAL	MTG. HOLES
<b>1286-ST</b>	.020 (.50) Brass, Tin Plate	.046 (1.2) Dia.
<b>1213-ST</b>	.032 (.80) Brass, Tin Plate	.052 (1.3) Dia.

**.205 (5.2) TAB**

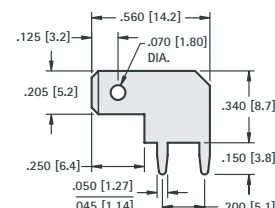

CAT. NO.	MATERIAL	MTG. HOLES
<b>4905</b>	.020 (.50) Brass, Tin Plate	.046 (1.2) Dia.
<b>4909</b>	.032 (.80) Brass, Tin Plate	.052 (1.3) Dia.



**.250 (6.4) TAB**

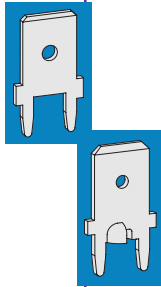
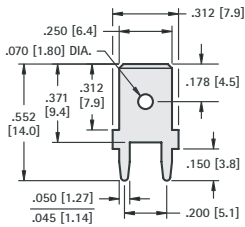

**.250 (6.4) TAB**

**STURDI-MOUNT**

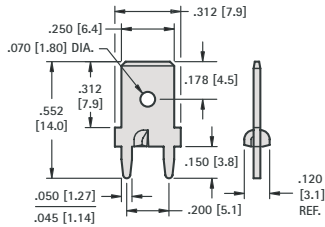

**DUAL .110 (2.8)/.250 (6.4) TAB**

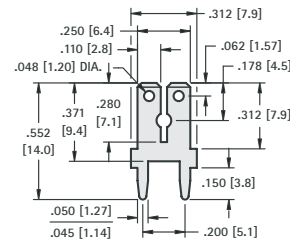

CAT. NO.	MATERIAL	MTG. HOLES
<b>1287</b>	.032 (.80) Brass, Tin Plate	.052 (1.3) Dia.

CAT. NO.	MATERIAL	MTG. HOLES
<b>1287-ST</b>	.032 (.80) Brass, Tin Plate	.052 (1.3) Dia.

CAT. NO.	MATERIAL	MTG. HOLES
<b>1282</b>	.032 (.80) Brass, Tin Plate	.052 (1.3) Dia.

**.250 (6.4) TAB**

**STURDI-MOUNT**

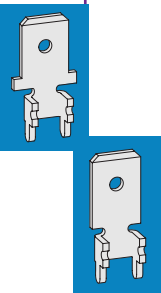
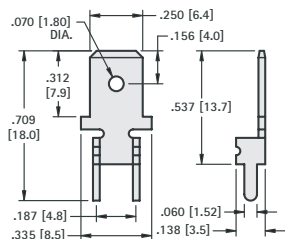

**.250 (6.4) TAB**

**STURDI-MOUNT**

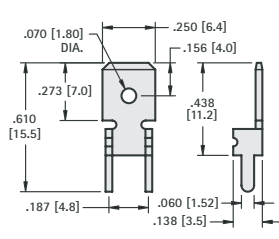

**.250 (6.4) TAB**

**STURDI-MOUNT**

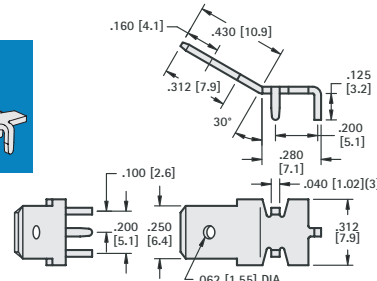

CAT. NO.	MATERIAL	MTG. HOLES
<b>4901</b>	.032 (.80) Brass, Tin Plate	.067 (1.7) Dia.

CAT. NO.	MATERIAL	MTG. HOLES
<b>4902</b>	.032 (.80) Brass, Tin Plate	.067 (1.7) Dia.

CAT. NO.	MATERIAL	MTG. HOLES
<b>4908</b>	.032 (.80) Brass, Tin Plate	.067 (1.7) Dia.

**.250 (6.4) TAB**

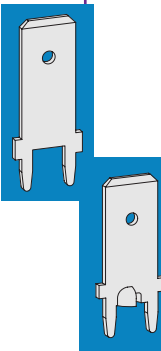
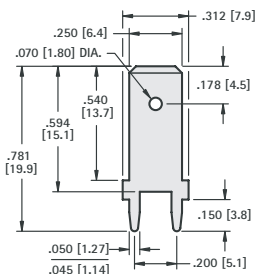

**.250 (6.4) TAB**

**STURDI-MOUNT**

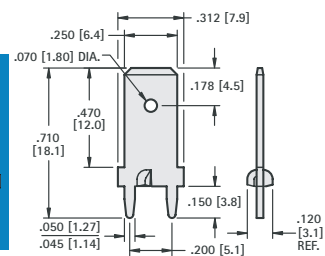

**.250 (6.4) TAB**

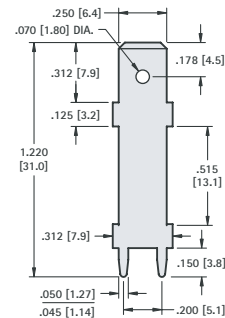

CAT. NO.	MATERIAL	MTG. HOLES
<b>1289</b>	.032 (.80) Brass, Tin Plate	.052 (1.3) Dia.

CAT. NO.	MATERIAL	MTG. HOLES
<b>1289-ST</b>	.032 (.80) Brass, Tin Plate	.052 (1.3) Dia.

CAT. NO.	MATERIAL	MTG. HOLES
<b>1281</b>	.032 (.80) Brass, Tin Plate	.052 (1.3) Dia.

**.250 (6.4) TAB**

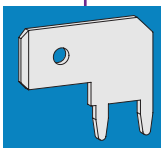
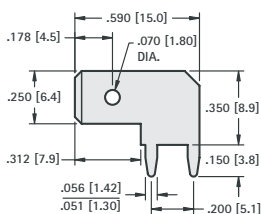

**.250 (6.4) TAB**

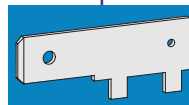
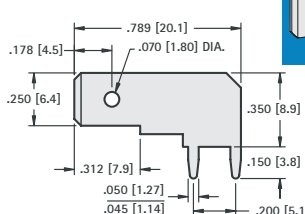

**.250 (6.4) TAB**

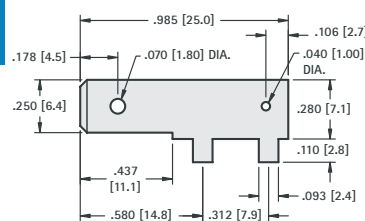

CAT. NO.	MATERIAL	MTG. HOLES
<b>4966</b>	.032 (.80) Brass, Tin Plate	.056 (1.4) Dia.

CAT. NO.	MATERIAL	MTG. HOLES
<b>1266</b>	.032 (.80) Brass, Tin Plate	.052 (1.3) Dia.

CAT. NO.	MATERIAL	MTG. HOLES
<b>1265</b>	.032 (.80) Brass, Tin Plate	.106 (2.7) Dia.

NOTE: .250 TAB HAND INSERTION TOOL: CAT. NO. 1288, REFER TO PAGE 46